



Alere BinaxNOW[®] *Legionella*

The Alere BinaxNOW[®] *Legionella* Urinary Antigen Card provides accurate, rapid detection of *Legionella pneumophila* serogroup 1 antigen with an easy-to-use technology, aiding physicians in providing rapid, focused therapy.

Accurate, Rapid Results Mean Focused Therapy Now

- **Highly accurate** – 95% sensitivity and specificity; treat with confidence
- **Easy-to-use** – Easy to manage and train; minimizes operator error
- **Results in 15 minutes or less** – Faster throughput in lab or Emergency Department; aiding in rapid, focused therapy
- **Room temperature storage** – Doesn't take up valuable refrigerator space

Cost-effective Detection of *Legionella* for Legionnaires Disease

- Urinary Antigen Tests recommended as part of the IDSA/ATS CAP Guidelines¹
- Decrease mortality rate²
- Decrease number of broad-spectrum antibiotics prescribed
- Shorten patient wait time/hospital stay
- Decrease need for unnecessary ancillary testing
- Improve patient outcomes through rapid, focused therap



To learn more about cost-effective, sensitive, rapid detection of *Legionella*, contact your local Alere Representative

Alere BinaxNOW® Legionella Performance

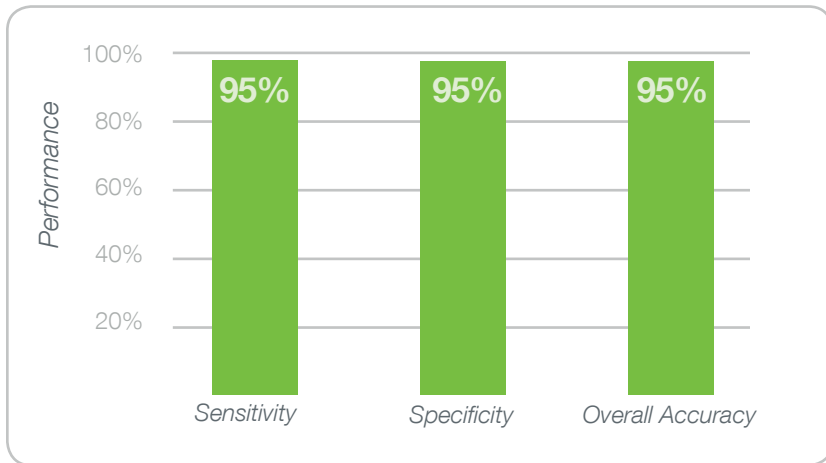

Package Insert Data*.
See product for complete performance characteristics

Easy to Use

- 1** Dip swab into urine specimen, then place swab into device.

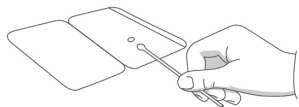

- 2** Add reagent to swab, then close device.

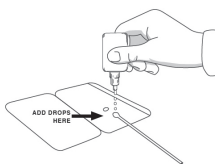

- 3** Read at 15 minutes.



For complete instructions for use, see the package insert.

Easy to Read

- 1.** One line = **Negative**



- 2.** Two lines = **Positive**

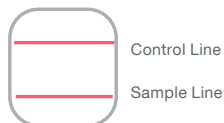

Order Information

**Alere BinaxNOW® Legionella
Moderately Complex
22 Test Kit**
Catalog No. **BNX852000**
CPT® Code: 87899

Control Swab Pack
Catalog No. **BNX852010**

*Compare to culture

1. Mandell, L. et al. Infectious Diseases Society of America/American Thoracic Society Consensus Guidelines on the Management of Community-Acquired Pneumonia in Adults. *Clinical Infectious Diseases* 2007; 44:S27-72.
2. Benin, A. et al. Trends in Legionnaires Disease, 1980-1998: Declining Mortality and New Patterns of Diagnosis. *Clinical Infectious Diseases* 2002; 35:1039-46.

© 2014 Alere. All rights reserved. The Alere Logo, Alere and BinaxNOW are trademarks of the Alere group of companies. The Fisher Healthcare Logo is a trademark of Fisher Scientific Company, L.L.C. 3000231-01 06/14 BN0630145

In the United States:

For customer service, call 1-800-640-0640
To fax an order, use 1-800-290-0290
To order online: www.fisherhealthcare.com

