

© 2020 Abbott. All rights reserved. All trademarks referenced are trademarks of either the Abbott group of companies or their respective owners. Software © 2020. Axxin, used under license. All trademarks referenced are trademarks of their respective owners.

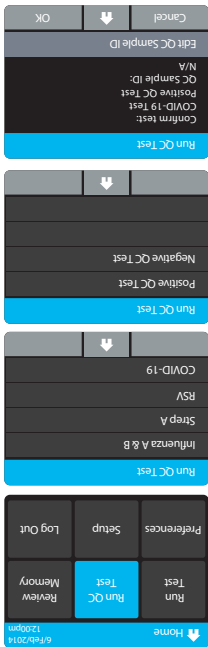

Confirm the test type to match the QC sample intended for testing by touching 'OK' and following the on screen prompts to complete testing.

Select the QC Test to be Run.

Select 'COVID-19' from the menu.

Touch 'Run QC Test'.

External Positive and a Sterile Swab for Negative Control should be tested once with each new shipment received and once for each untrained operator. For QC testing, select Run QC Test in the ID NOW Instrument User Manual for further details. Refer to Running a QC Test in the ID NOW Instrument User Manual for further details.

**Abbott Diagnostics Scarborough, Inc.**  
 10 Southgate Road  
 Scarborough, Maine 04074 USA  
 Latin America + 57 (1) 48242033  
 Europe & Middle East + 44 161 483 9032  
 Canada + 1 800 818 8335  
 Asia Pacific + 61 7 3363 7711  
 Africa, Russia, CIS + 44 161 483 9032  
 US + 1 855 731 2288  
 ts.csr@abbott.com  
 EMProductsupport@abbott.com  
 AProductsupport@abbott.com  
 CAProductsupport@abbott.com  
 LProductsupport@abbott.com

Further information can be obtained from your distributor, or by contacting Technical Support on:

**Technical Support Advice Line**

Manual of Clinical Microbiology, 11th Edition, Vol. 1, ASM. (2015) pg. 279.

**Throat Swab**  
 Collect patient specimen by swabbing the posterior pharynx, tonsils and other inflamed areas. Avoid touching the tongue, cheeks and teeth with the swab. Rayon swabs are not suitable for use.

**Nasopharyngeal Swab**  
 To collect a nasopharyngeal swab sample, carefully insert the swab into the nostril exhibiting the most visible drainage, or the nostril that is most congested if drainage is not visible. Pass the swab directly backwards without tipping the swab head up or down. The nasal passage runs parallel to the floor, not parallel to the bridge of the nose. Using gentle rotation, insert the swab into the anterior nares parallel to the palate advancing the swab into the nasopharynx, leave in place for a few seconds, and then slowly rotate the swab as it is being withdrawn. To ensure proper collection, the swab should be passed a distance that is halfway of that from the nose to the tip of the ear. This is about half the length of the swab. **DO NOT USE FORCE** encountered, withdraw the swab a little bit without taking it out of the nostril. Then elevate the back of the swab and move it forward into the nasopharynx.

**Nasal Swab**  
 To collect a nasal swab sample, carefully insert the swab into the nostril exhibiting the most visible drainage, or the nostril that is most congested if drainage is not visible. Using gentle rotation, push the swab until resistance is met at the level of the turbinates (less than one inch into the nostril). Rotate the swab several times against the nasal wall then slowly remove from the nostril. Using the same swab, repeat sample collection in the other nostril. Puritan Purflock Standard Tip Ultra Flocked Swabs, Puritan Purflock Mini Tip Ultra Flocked Swabs and Copan Standard Rayon Tip Swabs are not suitable for use.

**SPECIMEN COLLECTION and HANDLING**

Use freshly collected specimens for optimal test performance. Inadequate specimen collection or improper sample handling/storage/transport may yield erroneous results.



**ID NOW COVID-19 QUICK REFERENCE INSTRUCTIONS**

**Materials Required to Run a Test:**



Test Base



Sample Receiver



Transfer Cartridge



Patient Swab

**Instrument:**

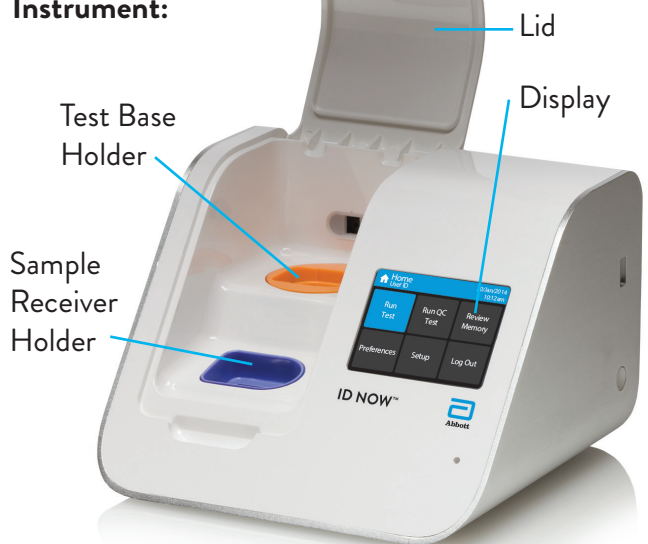

**For Use Under an Emergency Use Authorization (EUA) Only.**

Refer to the ID NOW COVID-19 Product Insert and User Manual for complete instructions.

# ID NOW™ COVID-19 QUICK REFERENCE INSTRUCTIONS

Before performing this test, refer to the ID NOW COVID-19 Product Insert and User Manual for complete Test Procedure and additional information.

Follow the step-by-step instructions shown on the instrument screen.

1



2

15°C - 30°C

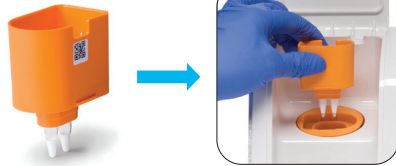

3

15°C - 30°C



Do not open the Sample Receiver before placing in the instrument.

4



5

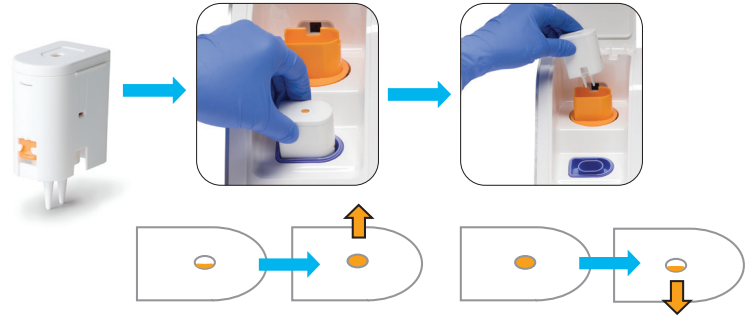

6



7

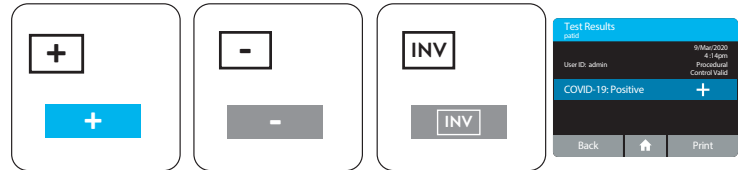



Refer to Product Insert instructions for retest procedure in the case of an Invalid result.

8



Refer to the Product Insert for instructions on safe handling and disposal of samples and test components.

<p>Abbott ID NOW COVID-19</p>	<p><b>Printed Colors</b></p>  <p>CMYK</p>	<p>PN: IN190001 Rev: 4</p>
<p>QRI, EN</p>	<p><b>Incoming Inspection Colors (For Reference Only)</b> Colors below are not used for printing</p>	
<p><b>Size:</b> 8.5 in. x 11 in.</p>	 <p>PMS 2995 U Primary Blue</p> <p>PMS 303 U Dark Blue</p> <p>PMS 224 U Magenta-Pink</p>	<p><b>Date of Last Revision:</b> 4.1 2020/05/04</p>