



Ovation. | F1

Ovation. | F2

Ergonomically designed fixed volume pipettes.

Why a new design? Because traditional pipettes have traditional problems: they're far from comfortable, too long...and so wrong. Using them for more than short periods of time can become a pain in the neck. And back. And shoulder, arm, wrist and hand. They simply were never designed to meet the needs and motions of your body. That's exactly why we developed the Ovation BioNatural™ Pipette. It looks different, works better and feels much more comfortable than any pipette you've ever used.

Ovation represents an entirely new approach to pipette design. Its very shape and operating position reinforces ergonomically-correct pipetting by encouraging the users hand, wrist, and arm to assume more natural postures during use. This permits muscles and joints to operate with minimum effort levels, thereby reducing discomfort, fatigue and risk of work-related injuries – while increasing efficiency and accuracy.

Fixed volume Ovation BioNatural Pipettes are the ideal ergonomic choice where pipetting volumes never deviate from an exact protocol. Both single stroke and two stroke (with overblow) models are available in volume increments from 1µL to 1000µL, and additional custom volumes are available upon request. All Ovation pipettes, both fixed volume and adjustable volume models, share an identical structure designed for ergonomically-correct pipetting.

Axial design versus Ovation

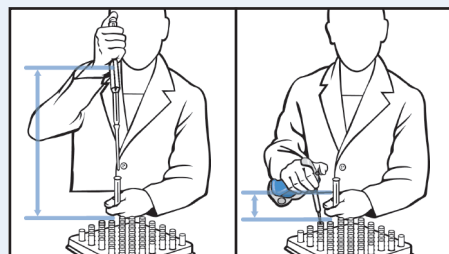

Comparison of arm and elbow elevation during aspirating and dispensing

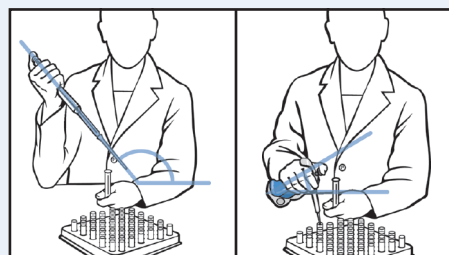

Comparison of forearm and wrist angles during aspirating and dispensing

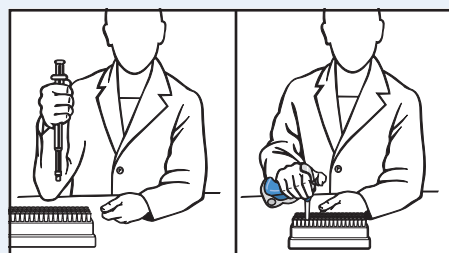

Comparison of arm and wrist posture when applying tips

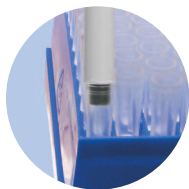

Tip Acquisition The user inserts the pipette's nozzle into a tip and lightly presses down until an audible "click" is heard. No excessive force or jamming is required to ensure a good seal.

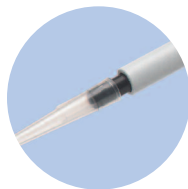

Liquid Blocking Disposable Nozzle

Not every pipetting task requires a filtered tip, but every pipette should be protected from contamination no matter what the task. Ovation comes with a filtered nozzle that won't let liquid into the body of the device.



Aspirating & Dispensing A very low-force, form-fitting plunger allows the user to manually control the speed of aspirating and dispensing with minimal contact or thumb effort.



Tip Ejection A low-force energy release button activates Ovation's tip ejector. A gentle push is all that's needed, ensuring that the forces needed to discard a tip are well below threshold levels recommended by ergonomists.

Fixed Volume Models	Fisher Scientific Catalog No.		Color	Volume †	Accuracy	Precision
	Single Stroke	Two Stroke				
		22-146-617	●	1µL	±2.7%	1.80%
		22-146-618	●	2µL	±1.5%	0.90%
	22-146-606	22-146-619	●	5µL	±1.5%	0.60%
	22-146-607	22-146-620	●	10µL	±1.5%	0.50%
	22-146-608	22-146-621	●	20µL	±1.0%	0.30%
	22-146-609	22-146-622	●	25µL	±1.4%	0.60%
	22-146-610	22-146-623	●	50µL	±0.8%	0.24%
	22-146-611	22-146-624	●	100µL	±0.8%	0.15%
	22-146-612	22-146-625	●	200µL	±0.8%	0.15%
	22-146-613	22-146-626	●	250µL	±1.2%	0.30%
	22-146-614	22-146-627	●	300µL	±1.0%	0.25%
	22-146-615	22-146-628	●	500µL	±0.8%	0.20%
	22-146-616	22-146-629	●	1000µL	±0.8%	0.15%



VistaLab Tips – A fitting companion.

To maximize the exceptional performance and benefits of the Ovation Pipette, we recommend using VistaLab tips. "One-size-fits-all" substitute tips can (and probably will) have negative effects on ease of use and performance. VistaLab tips provide a perfect fit **every time** and are available in a variety of volume sizes and packaging configurations.



© 2015 Thermo Fisher Scientific Inc. All rights reserved. Trademarks used are owned as indicated at www.fishersci.com/trademarks.

In the United States:
 For customer service, call 1-800-766-7000
 To fax an order, use 1-800-926-1166
 To order online: www.fishersci.com

In Canada:
 For customer service, call 1-800-234-7437
 To fax an order, use 1-800-463-2996
 To order online: www.fishersci.com